



Green Pin® EE Swivel

Swivel with eye-eye end-fittings



Highlights

- ✓ High tensile steel
- ✓ Galvanization assures long-term durability
- ✓ Superior stock availability of 99%
- ✓ Reliable Green Pin® quality and support
- ✓ High tensile steel

Description

The Green Pin® EE Swivel is a swivel with eye-eye end-fittings. The swivel is made from high tensile steel and can be used under water. Galvanization of the Green Pin® EE Swivel ensures its long-term durability. The swivel is available in a range with a working load limit from 0.4 up to 20.5 ton.

Product details

Productcode	G-7713
Material	high tensile steel, quenched and tempered
Safety factor	MBL equals 5 x WLL
Finish	hot dipped galvanized
Certification	2.1 2.2
Standard	U.S. Federal Specification RR-C-271, Type VII, Class 2

www.greenpin.com



Green Pin® EE Swivel

Technical specifications in millimeters

Article code	working load limit	Net weight	A diameter	B length outside	C width outside	D length inside	E width inside	F length inside	G length	Net weight (kg)
WTGPOO06	0,4	0.10	6	87	32	18	19	27	75	0.10
WTGPOO08	0,6	0.18	8	107	41	21	25	32	91	0.18
WTGPOO10	1,12	0.30	10	131	51	24	32	38	111	0.30
WTGPOO13	1,63	0.60	13	164	64	33	38	51	138	0.60
WTGPOO16	2,4	0.10	16	198	76	40	45	61	166	0.10
WTGPOO19	3,3	1.79	19	221	89	45	51	67	183	1.79
WTGPOO22	4,54	2.55	22	257	102	53	57	78	213	2.55
WTGPOO25	5,7	4.06	25	298	114	59	64	86	248	4.06
WTGPOO32	8,2	8.48	32	357	143	68	80	68	293	8.48
WTGPOO38	20,5	25.7	38	541	198	110	122	110	465	25.7



Green Pin® EE Swivel

Technical specifications in inches

Article code	working load limit	Net weight	A diameter (inch)	B length outside (inch)	C width outside (inch)	D length inside (inch)	E width inside (inch)	F length inside (inch)	G length (inch)	Net weight (LBS)
WTGPOO06	0,4	0.22	1/4	3 7/16	1 1/4	23/32	3/4	1 1/16	2 15/16	0.22
WTGPOO08	0,6	0.40	5/16	4 7/32	1 5/8	13/16	31/32	1 1/4	3 19/32	0.40
WTGPOO10	1,12	0.65	13/32	5 5/32	2	15/16	1 1/4	1 1/2	4 3/8	0.65
WTGPOO13	1,63	1.31	1/2	6 15/32	2 17/32	1 5/16	1 1/2	2	5 7/16	1.31
WTGPOO16	2,4	2.19	5/8	7 25/32	3	1 9/16	1 25/32	2 13/32	6 17/32	2.19
WTGPOO19	3,3	3.95	3/4	8 11/16	3 1/2	1 25/32	2	2 5/8	7 7/32	3.95
WTGPOO22	4,54	5.62	7/8	10 1/8	4 1/32	2 3/32	2 1/4	3 1/16	8 3/8	5.62
WTGPOO25	5,7	8.95	1	11 23/32	4 1/2	2 5/16	2 17/32	3 3/8	9 3/4	8.95
WTGPOO32	8,2	18.7	1 1/4	14 1/16	5 5/8	2 11/16	3 5/32	2 11/16	11 17/32	18.7
WTGPOO38	20,5	56.6	1 1/2	21 5/16	7 25/32	4 11/32	4 13/16	4 11/32	18 5/16	56.6



Green Pin® EE Swivel

Technical drawing

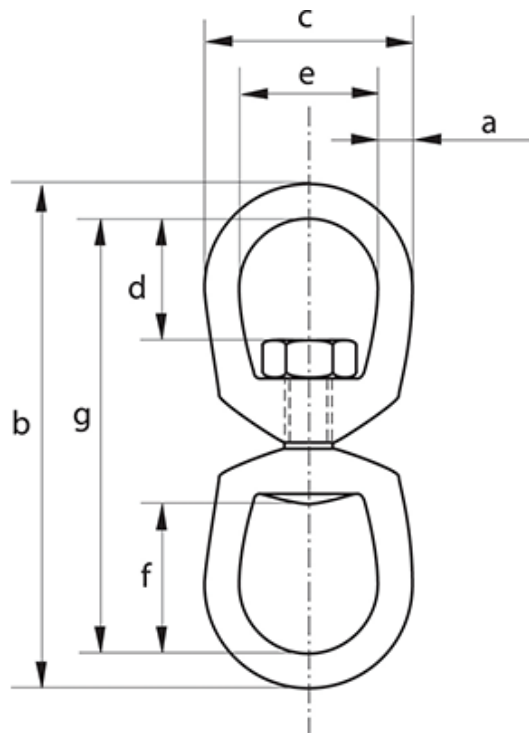

www.greenpin.com