



Green Pin® Grab Hook E GR10

Grade 10 eye grab hook

- **Material:** alloy steel, grade 10, quenched and tempered
- **Safety factor:** MBL equals 4 x WLL
- **Finish:** painted blue
- **Temperature range:** -40°C up to +200°C
- **Certification:** 2.1 2.2 3.1 MPI^b



UCRO

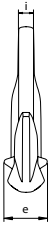
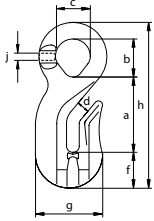

for chain diameter		working load limit	length	inside length eye	inside width eye	opening	thickness	width	width outside	length outside	width	thickness	weight each
mm	inch	t	a mm	b mm	c mm	d mm	e mm	f mm	g mm	h mm	i mm	j mm	kg
6	7/32	1.4	41	24	23	8	24	20	42	94	9	6	0.25
13	1/2	6.8	83	42	41	15	56	40	88	183	16	12	1.99



Green Pin® Grab Hook CL GR10

Grade 10 clevis grab hook

- **Material:** alloy steel, grade 10, quenched and tempered
- **Safety factor:** MBL equals 4 x WLL
- **Finish:** painted blue
- **Temperature range:** -40°C up to +200°C
- **Certification:** 2.1 2.2 3.1 MPI^b



UCRC

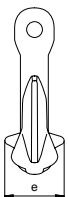
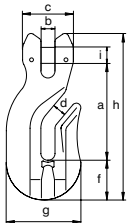

for chain diameter		working load limit	length	width	width outside	opening	thickness	width	width outside	length outside	diameter pin	weight each
mm	inch	t	a mm	b mm	c mm	d mm	e mm	f mm	g mm	h mm	i mm	kg
6	7/32	1.4	52	7	28	7	24	19	42	86	8	0.28
13	1/2	6.8	103	15	54	15	56	40	88	173	16	2.17