



## Green Pin® Foundry Hook E GR10

### Grade 10 eye foundry hook

- **Material:** alloy steel, grade 10, quenched and tempered
- **Safety factor:** MBL equals 4 x WLL
- **Finish:** painted blue
- **Temperature range:** -40°C up to +200°C
- **Certification:** 2.1 2.2 3.1 MPI® DGUV



UCFO

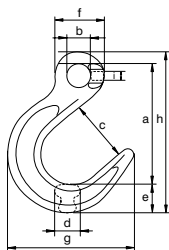

for chain diameter		working load limit	length	diameter eye inside	width opening	thickness	width	diameter eye outside	width outside	length	thickness	weight each
mm	inch	t	a mm	b mm	c mm	d mm	e mm	f mm	g mm	h mm	i mm	kg
6	7/32	1.4	93	18	48	17	22	38	97	124	6	0.33
8	9/32 - 5/16	2.6	124	25	63	22	29	50	129	165	8	0.78
10	3/8	4	157	33	80	28	36	65	161	208	10	1.5
13	1/2	6.8	190	44	96	36	46	84	198	256	13	3



## Green Pin Tycan® Grab Hook CL GR10

### Grade 10 clevis grab hook

- **Material:** alloy steel, grade 10, quenched and tempered
- **Safety factor:** MBL equals 4 x WLL and MBL equals 2 x Lashing Capacity
- **Finish:** painted blue
- **Temperature range:** -40°C up to +200°C
- **Certification:** 2.1 2.2 3.1 MPI®
- **Compatible with:** FCHLIFT1525; 5t (as shortening hook)  
FCHLASH1525; 10t (to connect to the loadbinder)



UCRCT

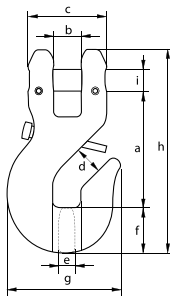

for chain size	working load limit	lashing capacity	length	width	width outside	opening	thickness	width	width outside	length outside	diameter pin	weight each
mm	t	t	a mm	b mm	c mm	d mm	e mm	f mm	g mm	h mm	i mm	kg
11x15	2.6		87	17	44	15	13	23	65	109	13	0.55
11x20	4		110	22	57	20	16	29	85	138	16	1.03
15x25	5	10	102	24	68	25	16	40	99	178	20	2
13x30	6.8		140	32	74	30	20	40	102	177	20	1.92

In inch

for chain size	working load limit	lashing capacity	length	width	width outside	opening	thickness	width	width outside	length outside	diameter pin	weight each
inch	t	t	a inch	b inch	c inch	d inch	e inch	f inch	g inch	h inch	i inch	lbs
7/16x19/32	2.6		3 7/16	21/32	1 3/4	19/32	1/2	29/32	2 9/16	4 10/32	1/2	1.21
7/16x25/32	4		4 11/32	7/8	2 1/4	25/32	5/8	1 5/32	3 1/3	5 7/16	5/8	2.27
19/32x1	5	10	4 1/32	15/16	2 11/16	1	5/8	1 8/16	3 29/32	7	25/32	4.4
1/2x1 3/16	6.8		5 1/2	1 1/4	2 29/32	1 3/16	25/32	1 8/16	4 1/32	6 31/32	25/32	4.23