

# Green Pin® Rotating Hoist Ring GR8

## Grade 8 rotating hoist ring

- **Material:** alloy steel, grade 8, quenched and tempered
- **Safety factor:** MBL equals 5 x WLL
- **Finish:** painted red or white
- **Temperature range:** -40°C up to +200°C
- **Certification:** 2.1 2.2 3.1 MPI® CE
- **Note:** WLL indicated hereunder are given in the worst conditions of use, i.e. 90°



ADA

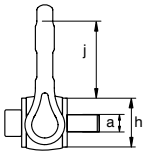
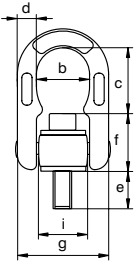

working load limit	diameter thread	width inside	length inside	diameter	length	thickness base	width outside	diameter base	diameter base	length inside	hex key	torque value	weight each
t	a mm	b mm	c mm	d mm	e mm	f mm	g mm	h mm	i mm	j mm	mm	Nm	kg
0.4	M8 x 1.25	35	41	13	18	35	68	34	38	43	6	6.5	0.43
0.7	M10 x 1.5	35	39	13	18	37	68	34	38	43	8	13	0.44
1	M12 x 1.75	35	36	13	22	39	68	34	38	43	10	22	0.46
1.3	M14 x 2.0	35	35	13	22	42	68	34	38	43	12	35	0.47
1.6	M16 x 2.0	35	42	13	28	43	68	34	38	52	14	55	0.52
2	M18 x 2.5	35	40	13	28	45	68	34	38	52	14	80	0.54
2.5	M20 x 2.5	35	38	13	32	47	68	34	38	52	17	110	0.59
3	M22 x 2.5	53	57	20	33	69	105	49	56	71	17	150	1.88
4	M24 x 3.0	53	55	20	39	71	105	49	56	71	19	190	1.93
5	M27 x 3.0	53	61	20	45	65	105	49	56	71	19	280	1.96
6.3	M30 x 3.5	53	61	20	45	65	105	49	56	71	19	380	2.03
7	M33 x 3.5	71	87	30	54	83	146	68	77	98	19	520	5.28
10	M36 x 4.0	71	87	30	54	84	146	68	77	98	19	600	5.35
10	M39 x 4.0	71	87	30	63	84	146	68	77	98	19	870	5.45
12.5	M42 x 4.5	71	87	30	63	84	146	68	77	98	19	1000	5.56